

TOPTECH

TMT BAR

500D

HOW TO BUILD YOUR **DREAM HOME**



Building is a structure made of raw materials, aspirations and emotions that make it a home. Thus your home has to have a strong backbone to hold up your dreams.

PLOT SELECTION

Important points to keep in mind while selecting **plot**

The plot should be either square or rectangle in shape.

Irregular shapes should be avoided or should be cured before construction.

The site should be level or sloping towards North or East or North-East.

The land is not prone to frequent flooding.

There are no known earthquake faults in close proximity to your plot.

The plot should not be under any acquisition/litigation proceedings.

Check for plot survey number and ensure that land title deed is clear.

Obtain a no objection certificate for the plot from the registrar's office.

Distance from work place, railway station, bus stand, and airport.

Availability of public amenities like road, water, electricity, drainage etc.

Availability of hospital, parks, recreational centres etc.

*According to vastu principles



Soil testing

Prior to the construction work, soil testing is essential as the black and clay soil can damage the construction in future.



DESIGNING

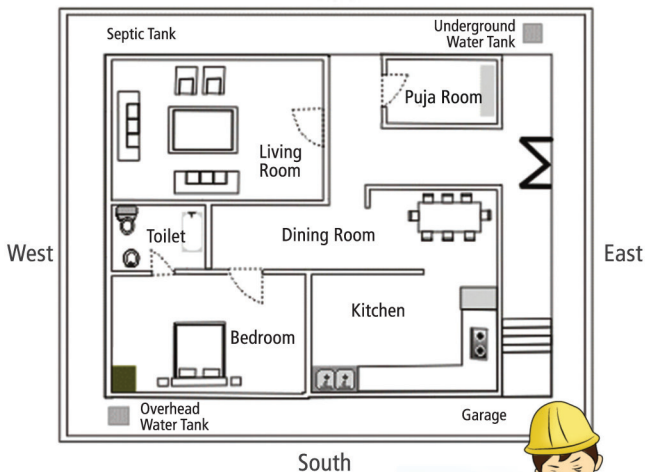

*Dummy floor plan

After the plot selection, you should hire a civil engineer to design the floor plan.



For best Vastu practices you would need to maintain the following:

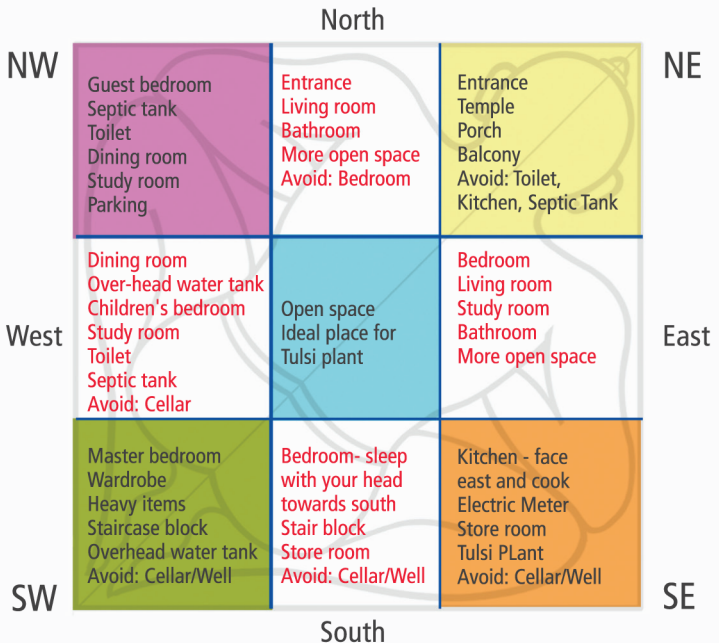

TMT BAR



Rebars are the most important component of building structure. Concrete alone cannot take tensile load. Steel rebars are cast into concreting to carry tensile load. Generally rebars available in the market are manufactured through TMT route.

The technical qualities that should be checked before buying **TMT** bars are:

- Corrosion Resistance
- Sturdy Build
- Fire Resistance
- Controlled Chemical Composition
- Seismic Resistance
- High Dimension Tolerance
- Superior Bend-ability
- Excellent Weld-ability



TopTech is the correct choice for TMT Bars balancing all these qualities clubbed together in one that ensures:

TOP Quality

Advanced technologies, such as the Tempcore Process - in collaboration with Centre de Recherche Metallurgiques (CRM), Belgium.

TOP Savings

Top technology yields more volume per ton, which is total cost benefit for consumers.



BUILDING MATERIALS

Foundation is the most important part of the construction.

You must dig minimum 4 feet depth and minimum 4ft/4ft area.

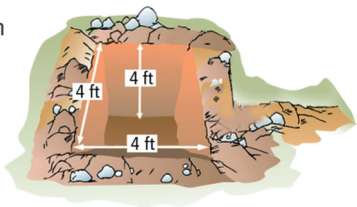
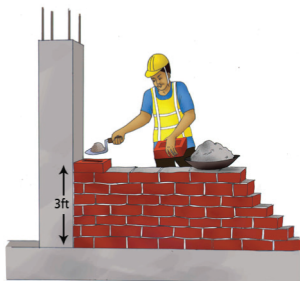

Bricks

Bricks must be soaked minimum for 24hrs. prior to their use. Also you should keep in mind that the laying of bricks should not exceed the height of 3 feet in a day.

Sand

Sand used for the construction purpose should be neat, clean and free from stone balls and other impurities. Give preference in selecting the finest of sand, as finer the sand, greater the sustainability the building gets.

Cement

Cement uniformity can be considered in cement purchasing decisions. It is important to evaluate variations in cement properties like physical and mechanical properties and chemical compositions and their effect on quality of concrete before choosing the perfect cement for your house.

Concrete

Concrete is a composite building material made from the combination of aggregate and a binder such as cement.

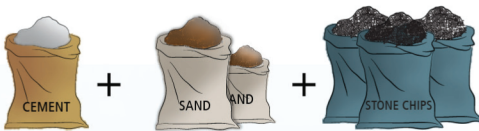

A concrete mixture ratio of 1 part cement, 1.5 parts sand and 3 parts aggregate will produce a concrete mix.

First you need to mix sand and stone chips, then add cement to the mixture and mix it well and finally add water.

For a concrete construction of any size, as concrete has a rather low tensile strength, it is generally strengthened using steel rods or TMT bars (known as rebars).



FINISHING

Don't forget to use construction chemicals during concrete mixture, before plastering and with wall paints, because they save your home from leakage problem, cracked roof, dampness, salt peter action etc.

Use SRMB RealBuild construction chemicals to solve all your household problems, all at once with a reasonable price.

Use termite proofing solution before the construction starts and water proofing solution during the work, to keep your dream home safe from external forces.

Prior to interior designing layout, co-ordination with the construction helps in certain design plans like the AC area, ceiling fan location etc.

Minute details to take care of while completing your house are:

Interior

Roof - It's important to install a moisture barrier on your roof even before it's completed.

Flooring - Carpet flooring or hardwood or composit cement flooring or tiles or marble flooring, go for the favourable flooring according to the house type and your choice.

Installation

Plumbing - Install the bath tub, shower enclosure, and any other large plumbing fixtures which will interface with finished walls. Make sure plumbing rough-ins are correctly located, and pipes are protected and securely anchored.

Electricity - All the wire and cables' work should be done under proper vigilance and special attention to be given on short circuit or such other hazards.

Furniture - Buy furniture according to the house type, interior and your taste.

Colouring - First coat with prime wall board, then apply a finish coat. Use a paint roller where possible, cutting-in with brushes around the crucial corners.

Electronic appliances - Make sure everything is working appropriately. Activate the water and electricity to start experimenting with your daily work.

Your dream home now awaits you and your family to enter and make memories. The base of the house must be strong enough to hold up those cherishing moments for lifetime.





TECH NIRMAN ISPAT PVT.LTD.

46, B.B.Ganguly Street, Kolkata 700012

Phone 033 2236 6666 / 9999

SMS TOPT to 56263

